

# STUDIO WALL SYSTEM

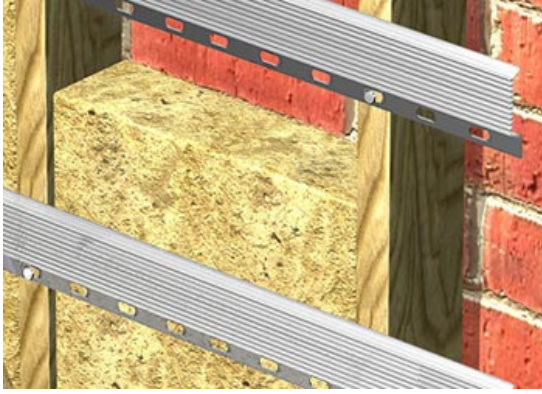

## Key Benefits

- A complete system that significantly reduces airborne noise through a wall.
- "Recording Studio" quality
- Reduces music and TV noise
- Reduces bass noise
- Effective on lightweight and single skin walls.
- Available from stock

## Description

The Studio Wall System is designed to absorb and reduce the amount of airborne noise which penetrates poorly insulated party walls. We have created this easy to order system for you but all the products can be purchased individually from other web pages on our site if preferred.

Supplied with all the following products included;

- Acoustic Mineral Wool (1.2m x 60cm square and 75mm thick)
- Resilient Bars (3m each in length)
- Soundproofing Mats (1.8m x 1.2m)
- Special Spray Adhesive (15oz 426 gram cans)
- Acoustic Sealant (380ml tube. 10.5 linear metres approx per tube)
- 2 x layers of Acoustic Plasterboard (12.5mm thick, 2.4m long and 1.2m wide sheets)

The system can be fitted by a handyman or builder or anyone with good D.I.Y experience. Our Acoustic Mineral Wool is placed between 75mm timber wall battens (Not supplied) and our Resilient Bar is then screwed horizontally over the battens as seen in the picture. Acoustic Plasterboard is then offered up to the Bars followed by a layer of Soundproofing Mat and finally another layer of Acoustic Plasterboard. The whole system is isolated off the surrounding walls and ceiling using a thin bead of our Acoustic Sealant. This system creates a floating wall that is capable of reducing louder noise such as bass and loud music more efficiently.

Once ordered the products are despatched with full step by step install instructions. Work out the area of your wall then use our product selector below to work out how much you need you can then order online or call us on 0845 363 7131.

<i>Your area in metre squared</i>	Acoustic Plasterboard (Based on 2 layers)	Resilient Bars	Acoustic Mineral Wool (AMW)	Soundproofing Mat (SBM5)	Acoustic Sealant	Special Spray Adhesive
1	1	2	2	1	1	1
2	2	3	3	1	1	1
3	3	4	5	2	2	2
4	3	5	6	2	2	2
5	4	6	8	3	3	3
6	5	7	9	3	3	3
7	5	8	10	4	4	4
8	6	9	12	4	4	4
9	7	10	13	5	5	5
10	7	11	15	5	5	5

**ADDITIONAL INFORMATION AND INSTALLATION DETAIL CAN BE FOUND ON OUR WEBSITE**