

## M20AD Soundproofing for Walls

### Technical Specification

Panel Size	:	nom. 1m x 1m x 20mm +/- 5%
Density	:	nom. 700kg/m <sup>2</sup>
Composition	:	Recycled rubber and binders
Thermal conductivity coefficient ( $\lambda$ )	:	EN1267 W/mK 0.12
Soundproofing performance	:	DnT,w (C;Ctr) = 56 (-3;-8)dB

Because this is a recycled product, sometimes foreign objects may be incorporated into the rubber. As long as these do not penetrate from one side of the panel to the other it will have little effect on the soundproofing properties once installed.

See illustrations below to see how M20AD Soundproofing can improve the sound insulation of a stud partition.

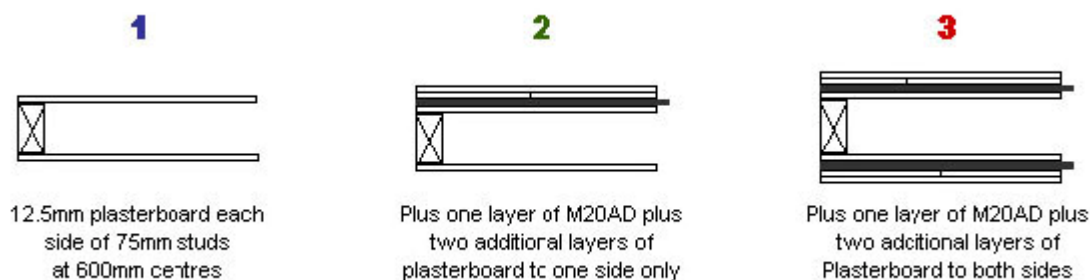

### Properties Values

Detail	Nominal partition Thickness (mm)	Approx weight (kg/m <sup>2</sup> )	Fire Resistance (hours)	Expected sound loss with no infill (db)	Min expected sound loss with AMW75 infill
1	100	19kg/m <sup>2</sup>	1/2	30	34
2	145	53kg/m <sup>2</sup>	1/2	40	45
3	190	87kg/m <sup>2</sup>	1	42	47

The estimated soundproofing performance of the stud partitions shown above are for partitions with no holes and all joints properly sealed. The sound insulation performance indicated may vary from site to site and should only be used as a guide.



The soundproofed wall shown in the detail below had a sound insulation value of 48dB DnT,W+Ctr which is approx. an 87% reduction in sound transmission and complies with the requirements of the latest Approved Document E Building Regulations. It is therefore, ideal for soundproofing walls, separating stairs and hallways where space is at a premium.



EST. 1969

Crawley Mill, Dry Lane, Witney, Oxfordshire, OX29 9TJ

sales@soundservice.co.uk

VAT NO: GB 434 5018 73 REG NO: 960986

Tel : 01993 704981

Fax : 01993 779569